

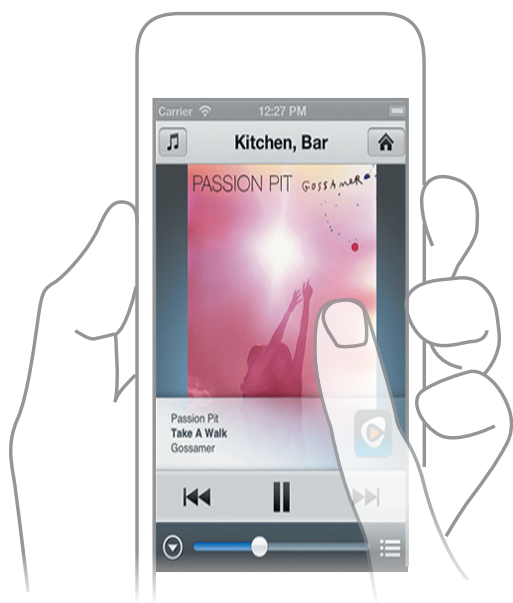

# NUVO®: MULTI-ROOM AUDIO SYSTEM



HIGH QUALITY  
DIGITAL MUSIC  
IN EVERY ROOM  
OF THE HOUSE





Eliot is the Legrand program dedicated to connected objects (Internet of things) which identifies all those products or systems which, because they can connect to the internet, give added value in terms of functionality, information, interactions with the environment and use.

# Contents

4-11

## General features

<b>NUVO</b> - high quality digital music in every room of the house	4
Wireless solution	6
Wired solution	7
System components	8

12-17

## Project guidelines

Type of LAN network	12
Player selection	14
Speaker selection and positioning	15

18-22

## Wiring diagrams

Example 1 - System wired for sound system in 4 zones with maximum power 2 x 20 W (centralised solution).	18
Example 2 - System wired for sound system in 4 zones with maximum power 2 x 20 W (stand-alone solution)	19
Example 3 - System wired for sound system in 3 zones with maximum power 2 x 50 W and extension with a wireless zone	20
Example 4 - wireless system for sound system in 4 zones with maximum power 2x60 W and integration with A/V amplifiers of other brands	21
Example 5 - Wireless system to play sound in 4 zones (one of which is dedicated to managing the TV sound) with a maximum power of 2 x 60 W	22

23-30

## Catalogue

# NUVO

HIGH QUALITY DIGITAL MUSIC  
in every room  
of the house



FROM RADIO BROADCASTS AND COLLECTIONS OF MUSIC ON CD....

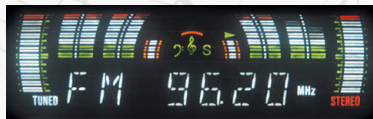

In recent years developments in electronics have contributed to a gradual replacement of analogue sound sources (FM radios, CD players etc.) by high-quality audio sources in digital format.

Stored on PCs, local hard disks and Cloud services as personal libraries or available streamed from the Internet, digital audio is more and more often played for local listening by Tablets and Smartphones.

## Rock music in the dining room, classical music in the bedroom and jazz music in the living room.

Legrand's **NUVO** solution is now available to play audio in various rooms in the home with Hi-Fi sound levels and quality.

Using zone players linked to high-quality speakers, **NUVO** allows you to listen to your favourite music saved on Smartphone or Tablet on storage devices (USB keys), shared online in iTunes and Windows Media libraries or available from Internet services such as streamed radio and Cloud services, in every room of the home, up to a maximum of 16.

All the functions are freely controlled by Tablet and Smartphone with a specific APP which can be downloaded free from the Android Play Store and the Apple Store.

## TO DIGITAL AUDIO SHARED VIA LAN NETWORK AND INTERNET



# Wireless SOLUTION

The ideal solution for flexible and fast systems with minimal structural interventions.

6.5" PLASTERBOARD SPEAKERS, SERIES 6



TABLETOP SPEAKER



WIRELESS ZONE PLAYER



Internet

ADSL

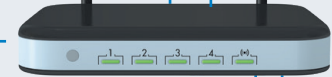

Modem/Router Wi-Fi

LAN

## The system

Easy to install and configure, the multiroom digital audio system consists of zone amplifier devices (players) connected to the speakers and to the home LAN network in order to listen to several audio files at the same time in the different rooms, up to a maximum of 16 audio files.

There are two installation modes:

- **wired solution**, suitable for new houses fitted with wired LAN network;
- **dual-band wireless (2.4 and 5 Ghz) solution** for existing homes or to extend wired systems, in rooms of new homes without wired LAN network.

# Wired SOLUTION

Ideal for sound systems in rooms with wired LAN network and to centralise players in racks.

OUTDOOR SPEAKER

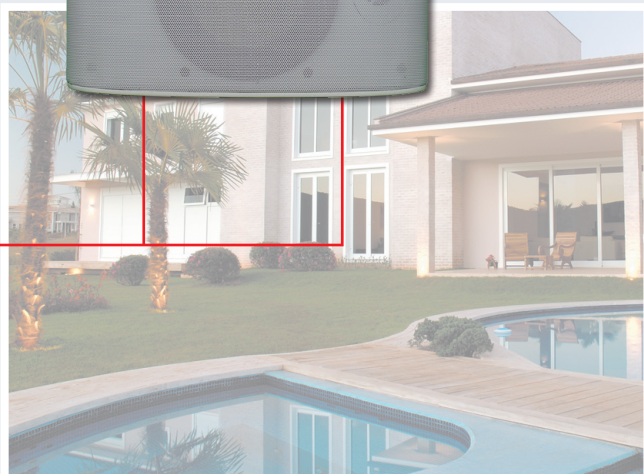
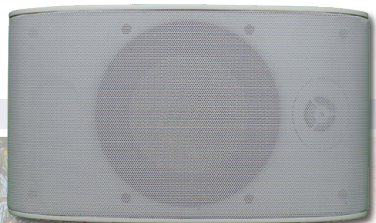

6.5" CEILING SPEAKERS, SERIES 2

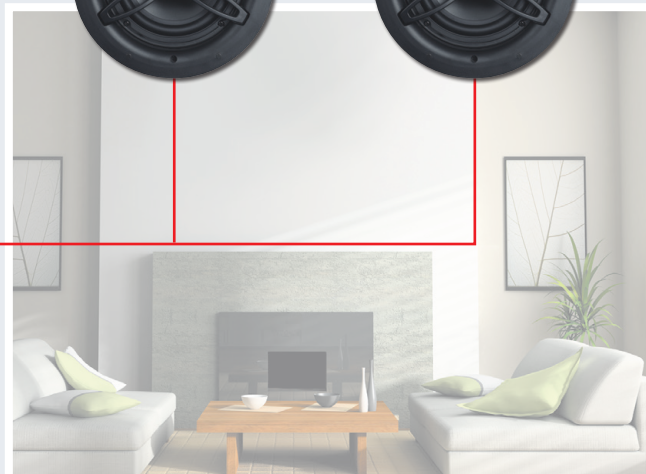

MULTI-ZONE PLAYER

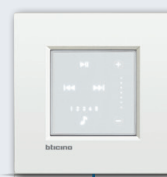

KEYPAD

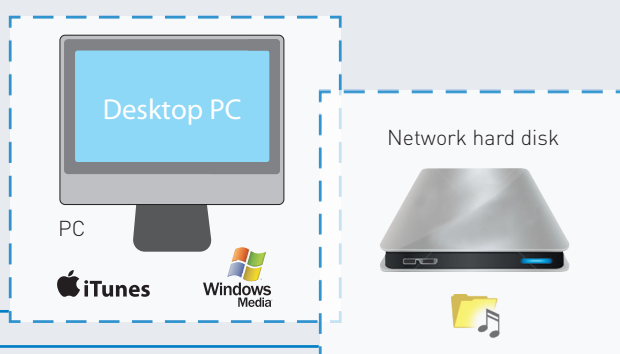

NUVO APP

## Connect and listen to

A specific APP, available free from the Android and iOS stores, configures the devices and manages all the system functions using just a Tablet or a Smartphone connected to the home Wi-Fi network.

# SYSTEM

## components

### Zone player

The players are Hi-Fi quality "Class D" audio stereo amplifier devices, connected to the home speakers and data network. They process and amplify audio signals.

They are available in different versions.

#### Zone player with integrated speaker

Made up of a speaker connected to a zone player, this Tabletop item NV-P400-EU allows you to listen to your favourite music in every room of the home with maximum freedom. Intended for tabletop installation, it can be used as a single zone player or as an extra player to extend the zones of an existing system.



#### Soundbar with subwoofer for Home Theatre

With a powerful 2.1 system, complete with an 8" wireless subwoofer, the Soundbar boosts listening experiences, playing movie, TV, or audio clarity. The Soundbar can also be used as a zone player which can guarantee access to music playlists in the network and streaming services.







## Rack professional multi-zone player

Player to be mounted in modular rack panels and to create a sound system in a maximum of three different zones.

There are two available powers for every zone:  
2x20 W RMS (item NV-P3100-EU) and  
2x55 W RMS (item NV-P4300-EU).

Suitable for wired LAN network connection.



NV-P3100-EU (3 zones 2x20 W)  
NV-P4300-EU (3 zones 2x55 W)

## Stand-alone zone player

Device for creating a sound system in one zone available in two versions: with power of 2x20 W RMS item NV-P100-EU and 2x60 W RMS item NV-P200-EU.

Suitable for wired and wireless network connection.



NV-P100-EU (2x20 W)  
NV-P200-EU (2x60 W)  
NV-P300-EU (preamplifier)

## Pre-amplified zone player

This device, item NV-P300-EU, is specially made to use an audio or audio/video power amplifier of other brands for the sound system of a zone.

## Available connections

The players have USB port and IN audio connector, to which mobile devices such as Pen drives and MP3/CD readers can be connected.

This solution allows further audio files to be added for home listening, as well as those stored in the devices on the LAN network (hard disk and computer) and those streamed via Internet.

The wireless player item NV-P200-EU can also be connected via Bluetooth to your tablet or smartphone to play your favourite playlists.

**NOTE:** the amplifier power refers to 8ohm speaker connection.

# SYSTEM components

## Speakers

The speakers are available with powers between 50 – 100 W RMS and with various shapes and modes of installation.

### Indoor speakers

They are ideal for ceiling and wall mounting and available in three different series:

- **SERIES 2:** speakers with polypropylene woofer for deep basses and tweeter with silk dome for crystal-clear sounds; applicable power up to 50W RMS.

- **SERIES 4:** speakers with glass fibre woofer for a minimum distortion and tweeter with aluminium dome for bright sounds; applicable power up to 75W RMS.

- **SERIES 6:** speakers with Kevlar and carbon fibre woofer for high powers and titanium tweeter for extreme performances; applicable power up to 100W RMS.



### Outdoor speaker

The new outdoor speakers feature powerful and crystalline sound thanks to the use of a woofer with 6.5" diameter. The elegant design combines small size and a modern appearance which fits perfectly in any space.





## The function control

### Touch screen item NV-P30-BK

Used as an alternative to the tablet, this wall-mounting device has an elegant 10" screen for complete control of the NUVO system. The touch screen already has an operation application.



### Keypad item NV-P20-ARMG and NV-P20-ARWH

Featuring an elegant front with backlit symbols, this device is a convenient flush-mounted control to manage the basic functions of a single zone player.

Also available in Magnesium and White versions.

### NUVO APP for system control

A single and specific app is available free from the Android Play Store or the Apple App Store for the configuration, system diagnostics and management of all the listening functions.

This will let you manage the entire NUVO system freely and anywhere in the house by selecting the audio sources (local audio libraries, Internet streaming services etc.) to be associated with the various rooms which will have a sound system.



Download the free APP



Look at the video for the configuration



# PROJECT GUIDELINES

The following factors must be taken into account when designing the NUVO audio multiroom system:

- A.** type of home LAN network available or to be created: wired or Wi-Fi.
- B.** number and type of player as a function of the zones to be fitted with a sound system and the audio power.
- C.** speaker type and positioning.

## A. TYPE OF LAN NETWORK

To use all the functions of the NUVO system it must be connected to a LAN network with Wi-Fi modem/router. The Internet connection must be available so that you can use the streamed music services and for any firmware updates of the products and the management APP.

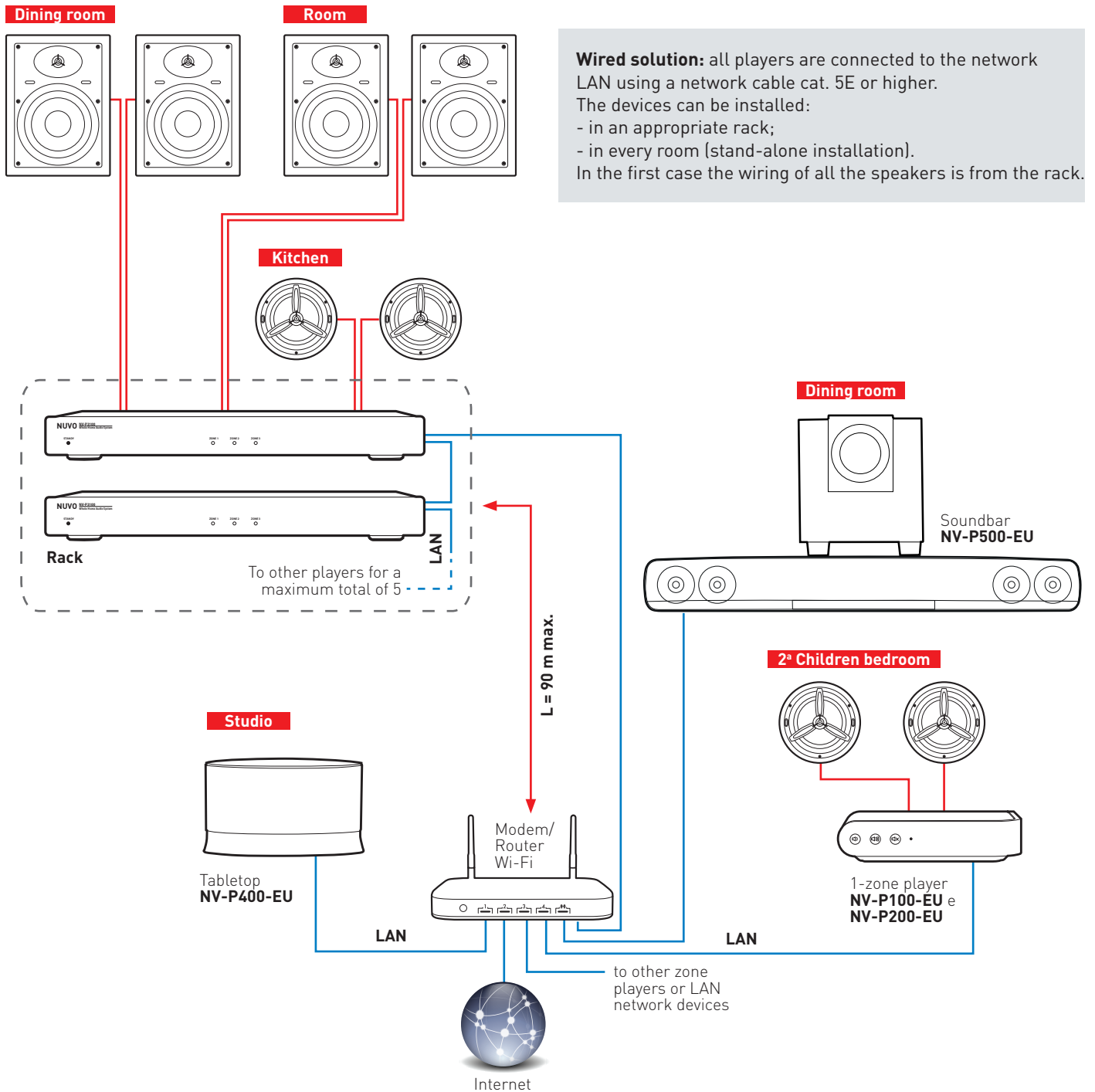

**Wired solution:** all players are connected to the network LAN using a network cable cat. 5E or higher. The devices can be installed:

- in an appropriate rack;
- in every room (stand-alone installation).

In the first case the wiring of all the speakers is from the rack.

**NOTE:** it is possible to create a system that can manage up to 16 different zones. Follow the provisions of the standards in force when making the LAN network data system. It is recommended the use of cables with cat. 5E or higher.

**Room**

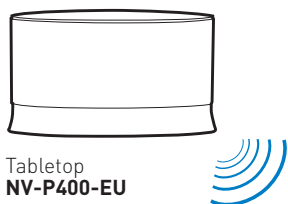

**Wireless solution:** in this case all the players with their speakers can be distributed freely in the various rooms.

**Dining room**

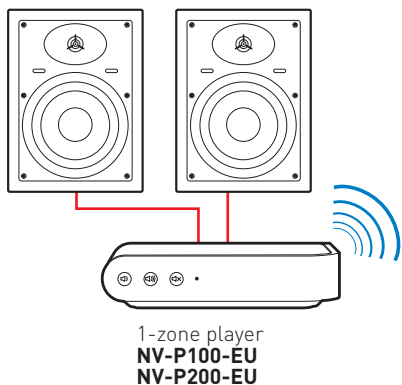

**Kitchen**

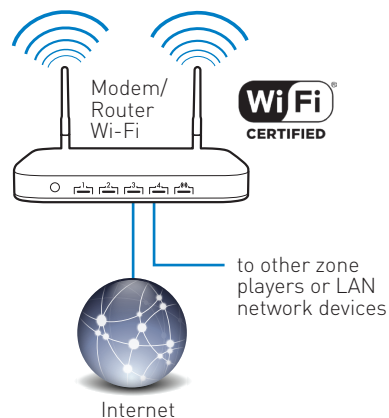
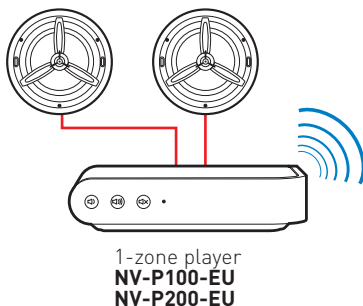

**Mixed solution (wired LAN with radio extension):** if sound systems are to be set up in rooms which do not have wired LAN network a mixed wired-radio system can be created.

**Dining room**

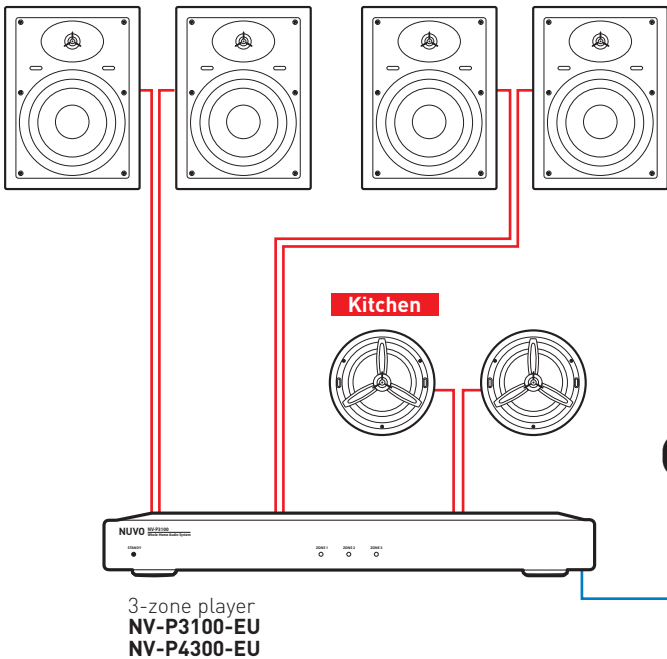

**Room**

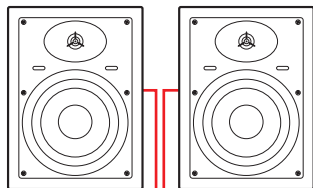

**Kitchen**

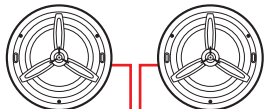

**Children bedroom**

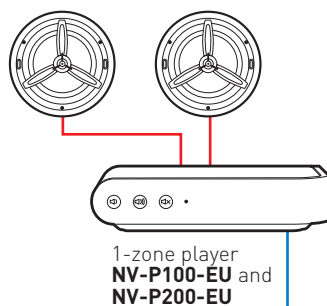

**Room**

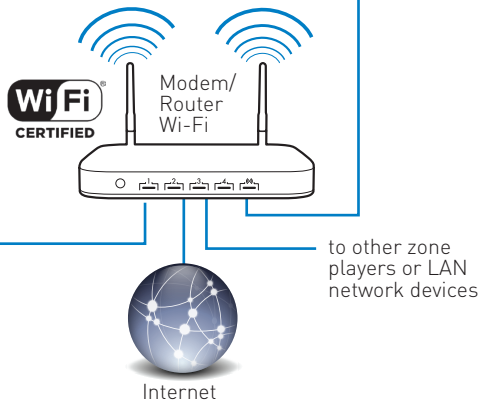
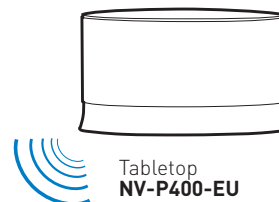

# PROJECT GUIDELINES

## B. PLAYER SELECTION

After establishing the type of system to make, with wired LAN network, Wi-Fi or mixed, select the player and speakers to be used with it taking account of:

- the user's listening habits: quiet background music or full volume;
- from the size of the room to be fitted with a sound system.

An applicable criterion in most cases is

to assign players with power 20W (per speaker) for sound systems in small rooms such as small kitchens, corridors, bathrooms and small bedrooms. Players with power more than 50W are suitable for sound systems in medium-large rooms such as living rooms, basements, master bedrooms and outside rooms. Consult the following table to select the players on the basis of the criteria stated above.

**Note:** in the design also consider any

external noise sources such as roads or industrial activities which could disturb listening to the music programme.

Player	Mounting	Connection to the LAN network	Bluetooth connection	No. of managed zones	Power per zone (8 Ohm speaker)	Power per zone (6 Ohm speaker)	Power per zone (4 Ohm speaker)
NV-P100-EU	stand-alone	Wired + Wi-Fi	NO	1	20 W x 2	n.d.	n.d.
NV-P200-EU	stand-alone	Wired + Wi-Fi	YES	1	60 W x 2	n.d.	60 W
NV-P4300-EU	rack	wired	NO	3	55 W x 2	55 W x 2	55 W x 2
NV-P3100-EU	rack	wired	NO	3	20 W x 2	n.d.	n.d.
NV-P300-EU	stand-alone	Wired + Wi-Fi	NO	1	-	-	-
NV-P400-EU	stand-alone	Wired + Wi-Fi	NO	1		n.d.	
NV-P500-EU	stand-alone	Wired + Wi-Fi	NO	1		n.d.	

### PREAMPLIFIER PLAYER ITEM NV-P300-EU

This device, without power amplifier, is not connected to the speakers but is designed to be connected to the input of any Hi-Fi amplifier already in the room. The amplifier thus becomes an integral part of the NUVO system to play streaming audio content from Internet Radio or in the home network.



### SOUNDBAR WITH SUBWOOFER ITEM NV-P500-EU

This device is the ideal solution to play high-quality sound from televisions or Audio/Video receivers. As well as these functions, the Soundbar can be used as a zone player performing the same functions as the stand alone players and rack.



## C. SPEAKER SELECTION AND POSITIONING

This operation must be carried out taking account of the features of the room where the sound system will be installed and the player selected.

Respect the following rule:

- with 20 W Players use speakers with maximum power of 50 W;
- with 50/60 W Players use speakers with maximum power of 75 W or 100 W.

All speakers are set up for installation in brick or plasterboard walls (using the appropriate metal box item NV-BOXIW6) or for false ceiling installation.



FLUSH-MOUNTED SPEAKERS  
for plasterboard walls

OUTDOOR SPEAKERS

## PARTICULAR SPEAKERS

Speakers with features customised for special applications are available in the NUVO product range.

### Angle speaker

These ceiling speakers have a front woofer and tweeter fixing flange horizontally oriented by 15 degrees to direct sound to the listening spot more efficiently.



ANGLE SPEAKER

### Stereo speaker

To be used in rooms which are too small for the installation of two speakers, to play stereophonic sound. The speaker has one woofer and two independent tweeters (one for the right channel and one for the left channel).

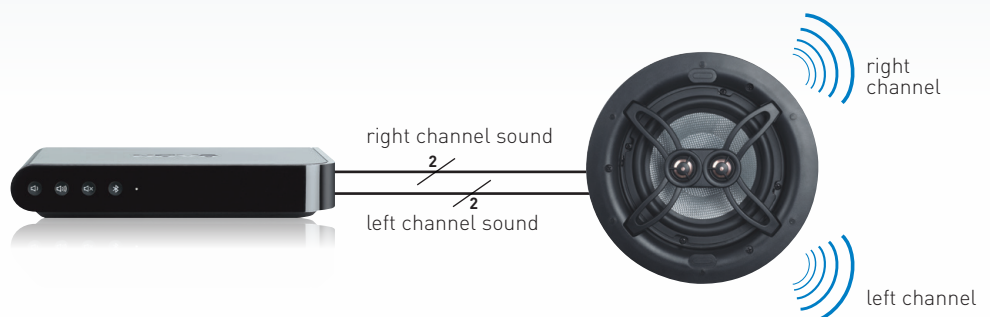

# PROJECT GUIDELINES

## C. SPEAKER SELECTION AND POSITIONING

The speakers must be positioned in the various rooms taking account of the user's needs.

If there is only one listening position because the listener wishes to experience the stereo effect, the two speakers must be positioned at the corners of an equilateral triangle and the listener must be at the vertex.

If the listening position is not a fundamental requirement, the speakers can be installed on the wall or the ceiling and so positioned that the sound is uniformly distributed in each room. In medium sized or large rooms there should be 2.5 – 3 metres between two or more speakers installed on the same wall to guarantee wide sound distribution. The following pictures show some installation examples.

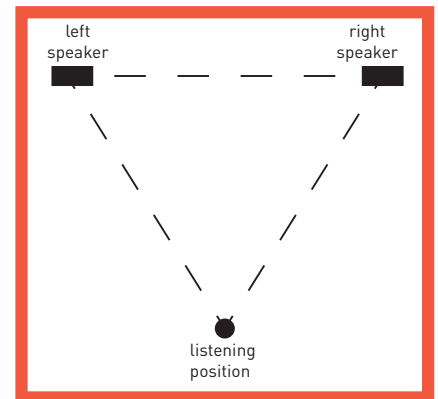

Positioning the speakers for stereophonic listening (room upper view)

### Installation examples

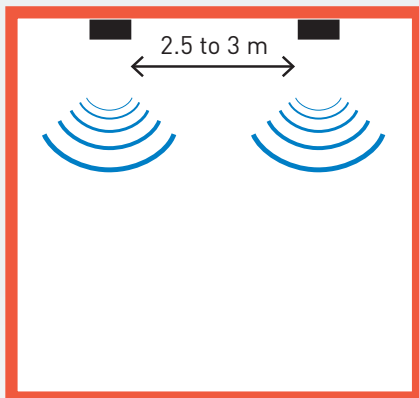

Fig. 1 - speaker positioning on the same wall (room upper view).

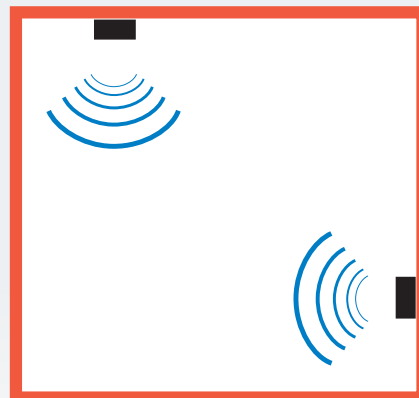

Fig. 2 - speaker positioning on two different walls (room upper view)

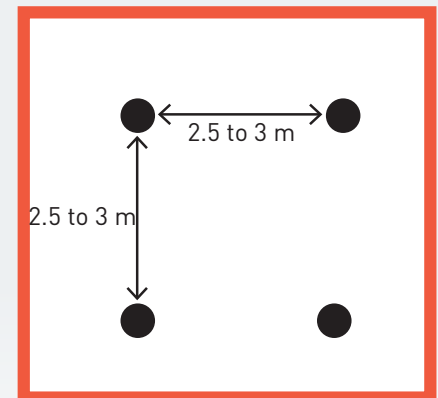

Fig. 3 - use of 4 ceiling speakers for sound system in large areas. Each pair of speakers is connected in parallel to each of the two outputs (right channel and left channel) of the player. This configuration is possible using only player item NV-P200-EU and item NV-P3500-EU and speakers with an impedance of 80hm (room upper view).

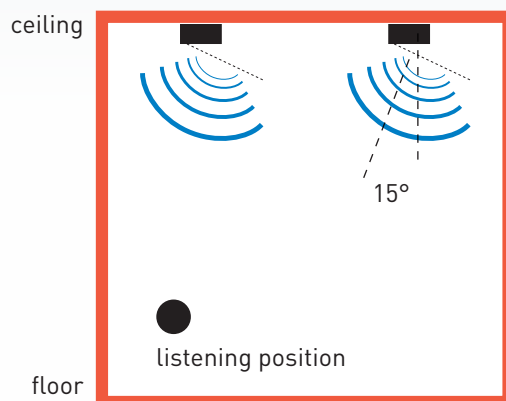

Fig. 4 - use of the ceiling "angle" speakers positioned for sound system in a specific area.



### Connection cable selection

The wire which connects the players to the speakers, by its nature, attenuates the signal depending on its cross-section and length. For short connections, the signal attenuation level is very low because the value of the resistance (indicated by  $R_c$  in the drawing to the side) is negligible with respect to the value of the  $R_L$  impedance of the speaker (typically 8 Ohm).

For very great distances or for wires with smaller cross-sections, the wire resistance  $R_c$  increases with consequent increase in the loss of useful signal.

The cable selection must therefore be made taking account of the connection wiring length between the player and the speaker as shown in the following table.

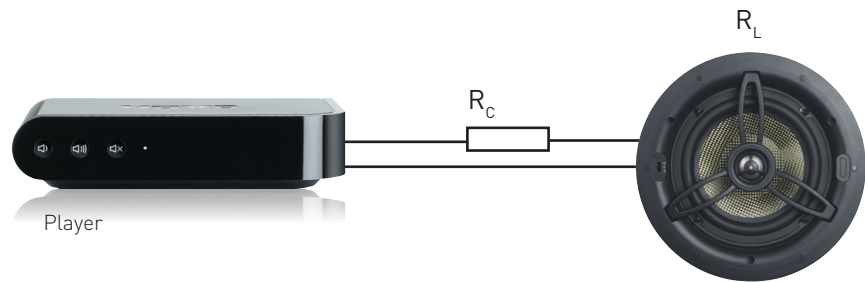

For the dimensions of the connection cables, refer to the data given in this table.

Maximum length of the Player connection cable - speaker (in metres)	Cable section (mm <sup>2</sup> )
5	1
15	1.5
30	2.5
over 30	more than 2.5

The player must be connected to the speakers respecting the colouring of the terminals: the player's red terminal should be connected to the speaker's red terminal and player's black terminal connected to the speaker's black terminal. Failure to respect this rule may lead to a reduction of the emitted signal (speaker's right channel and left channel not in phase) or may lead to damage to the player or to the speakers.

To avoid any errors wires with two conductors distinguished by different colours or printing should be used.

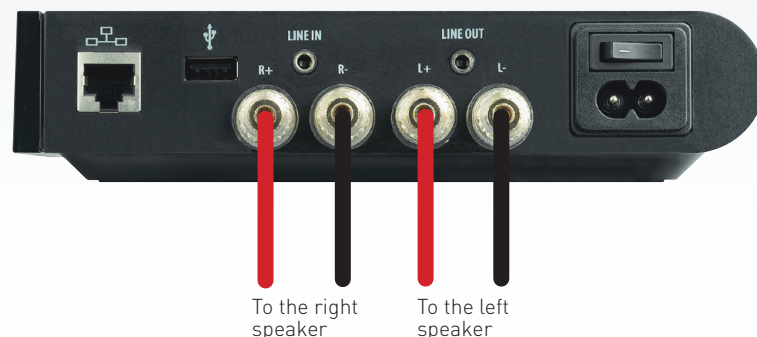

# WIRING DIAGRAMS

## EXAMPLE 1

SYSTEM WIRED FOR SOUND SYSTEM IN 4 ZONES WITH MAXIMUM POWER 2 X 55 W (CENTRALISED SOLUTION).

The diagram shows a new four-roomed apartment on a single floor with sound system fitted with wired and wireless LAN network. Two item NV-P4300-EU players will be used which can manage 3 zones each, centralised in an equipment room in the home; the first player manages the three zones (bedroom, bathroom and living room) and the second the fourth zone (kitchen). There are speakers item NV-2IW6 flush-mounted on the walls while in the smaller rooms such as the bathroom and the kitchen there are ceiling speakers item NV-2IC6.

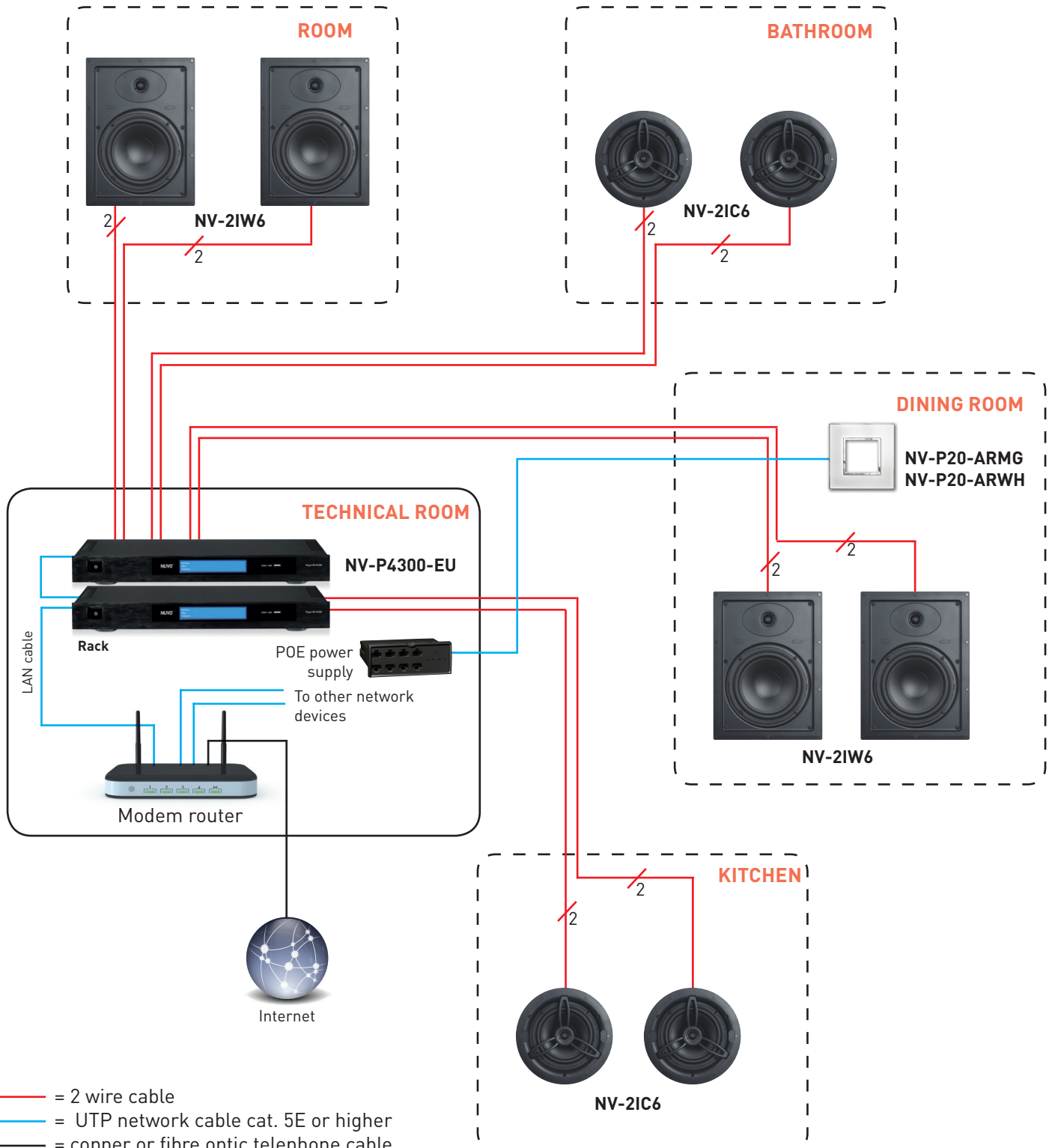

## EXAMPLE 2

### SYSTEM WIRED FOR SOUND SYSTEM IN 4 ZONES WITH MAXIMUM POWER 2 X 20 W (STAND-ALONE SOLUTION).

The system shown in the previous page can also be made using stand-alone player item NV-P100-EU. In this case a wired LAN network must be installed in the home to connect each player to the modem router.

The LAN network can be sized for the connection of other network devices (hard disk, PC etc.).

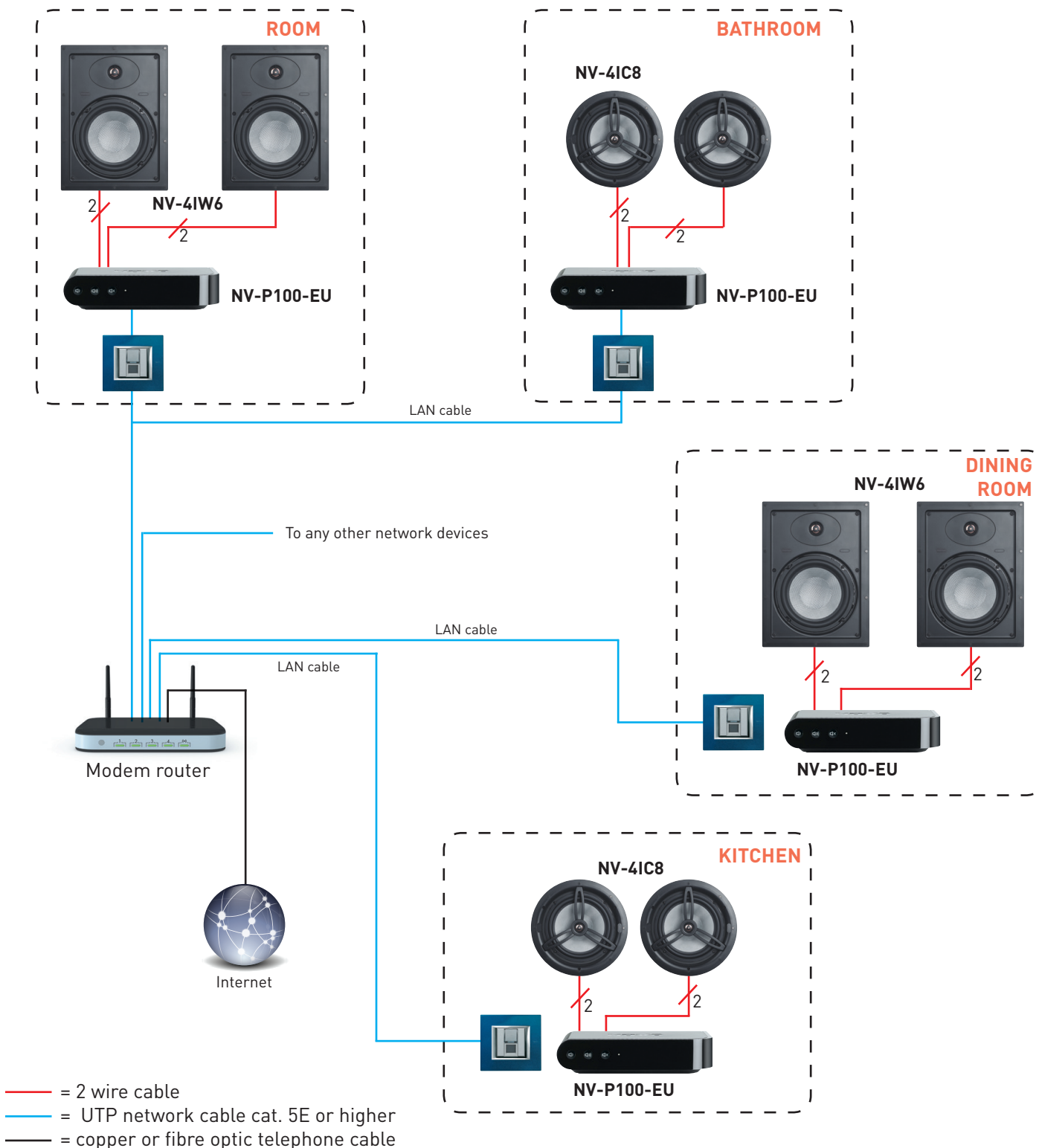

# WIRING DIAGRAMS

## EXAMPLE 3

SYSTEM WIRED FOR SOUND SYSTEM IN 3 ZONES WITH MAXIMUM POWER 2 X 55 W AND EXTENSION WITH A WIRELESS ZONE  
 The system shown illustrates the use of a player item NV-P4300-EU to manage 3 zones with maximum power 2 x 55W per zone. Use the Tabletop player item NV-P400-EU connected to the LAN via wi-fi to provide a sound system in the kitchen which does not have wired LAN.

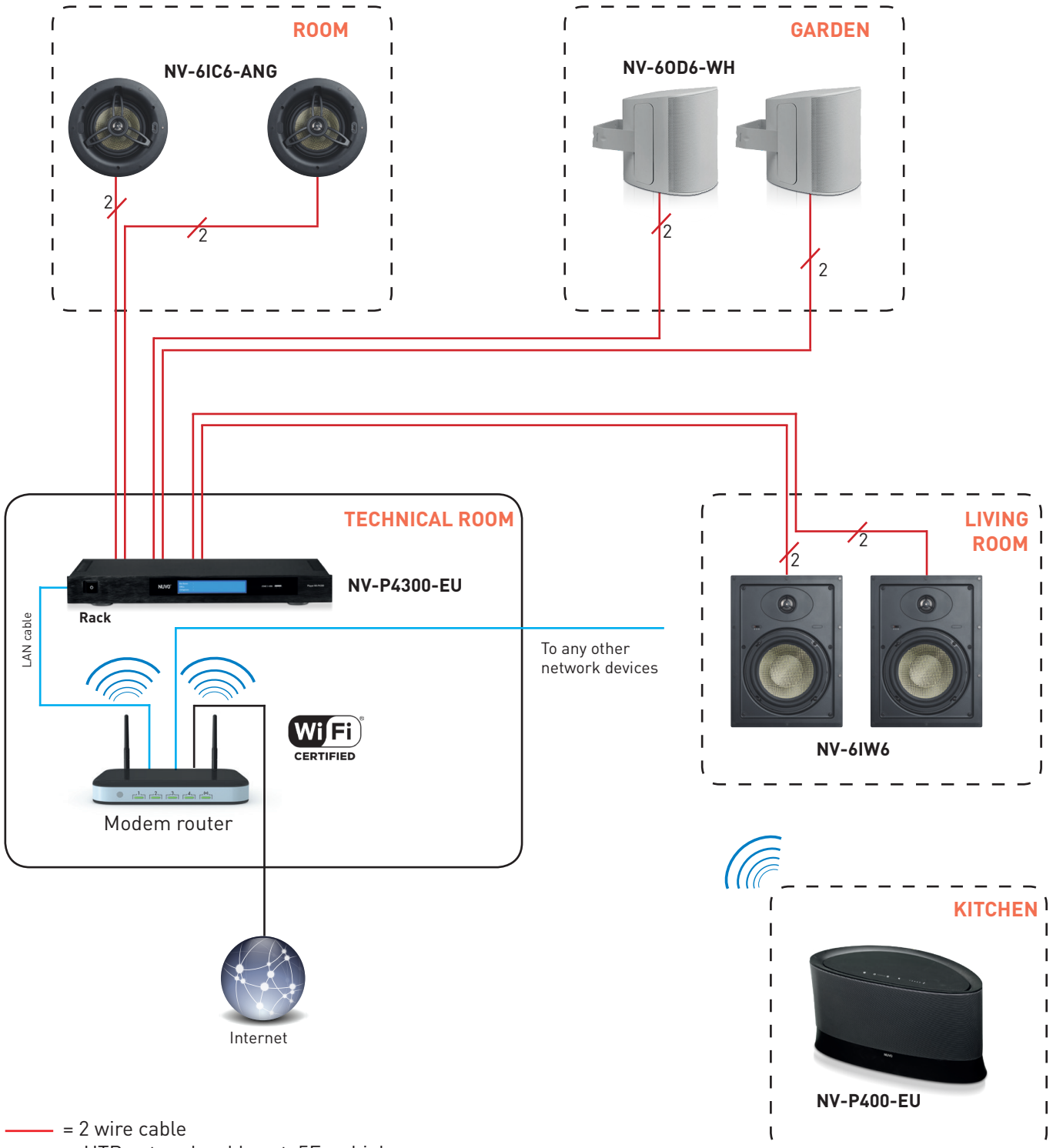

- = 2 wire cable
- = UTP network cable cat. 5E or higher
- = copper or fibre optic telephone cable

## EXAMPLE 4

### WIRELESS SYSTEM FOR SOUND SYSTEM IN 4 ZONES WITH MAXIMUM POWER 2X60 W AND INTEGRATION WITH A/V AMPLIFIERS OF OTHER BRANDS

This diagram shows the wireless system solution which is applicable in existing homes which do not have a wired LAN network, so that all players are interconnected to the router/modem via wi-fi.

For sound system in the tavern or in the garden, the players item NV-P200-EU with maximum power of 2x60W are used. The "living room" zone is managed using the preamplifier player item NV-P300-EU connected to the pre-existing Hi-Fi system. Use the tabletop player item NV-P400-EU to listen to music in the bedroom.

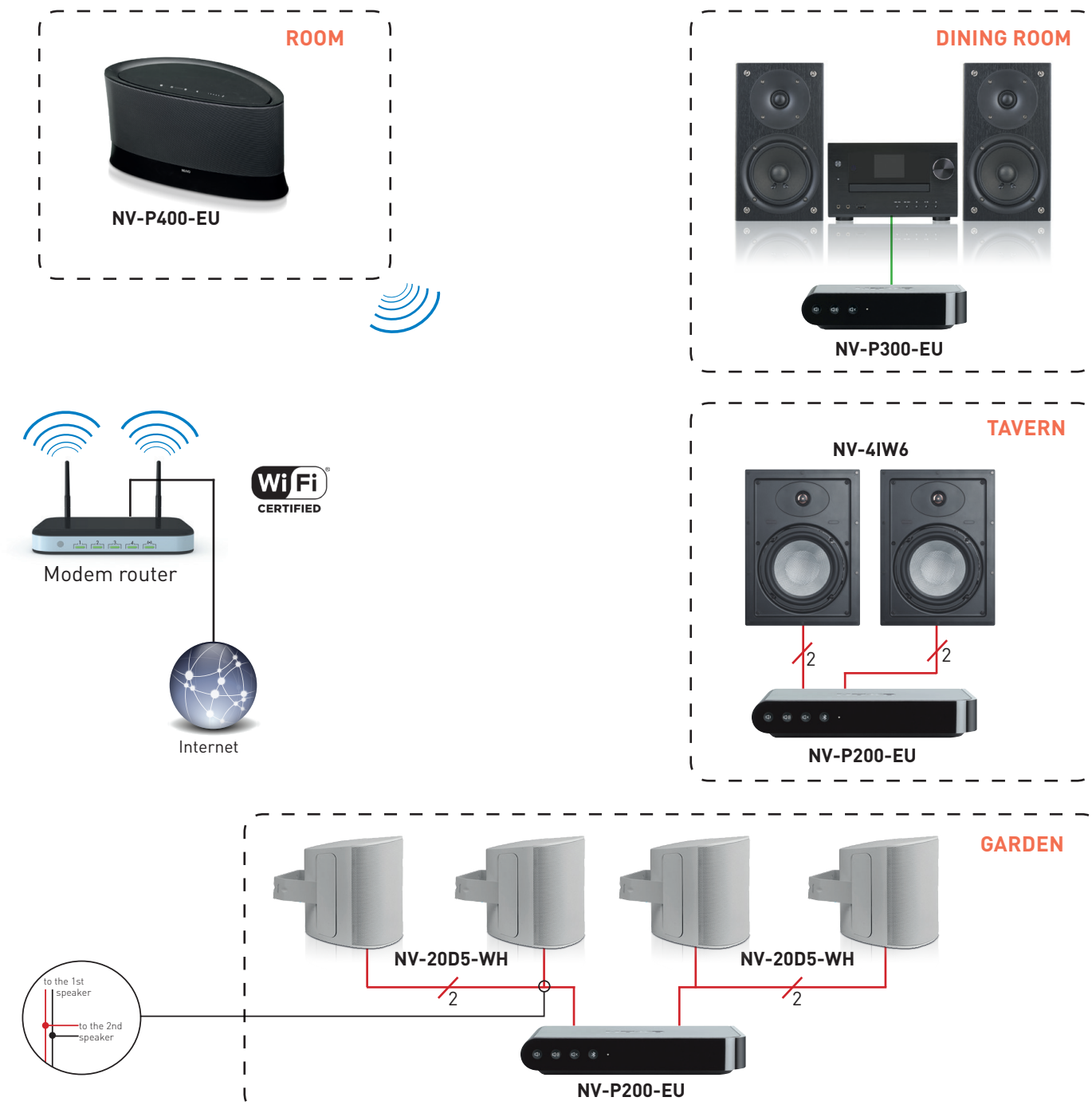

- = 2 wire cable
- = copper or fibre optic telephone cable
- = audio cable with RCA connectors

Connecting two speakers with impedance 8 Ohm in parallel gives a load with impedance 4 Ohm; with this value the player supplies more power, which is divided equally between the 4 speakers.

# WIRING DIAGRAMS

## EXAMPLE 5

WIRELESS SYSTEM FOR A SOUND SYSTEM IN 4 ZONES (ONE OF WHICH IS DEDICATED TO MANAGING THE TV SOUND) WITH MAXIMUM POWER OF 2X60 W.

Also in this diagram, the wireless system solution is shown.

The house contains a large tavern needing 4 speakers to distribute the sound evenly; these are connected "in parallel" to the right- and left-hand output sockets of the NV-P200-EU player with 60 W power.

In the living room, the TV is connected to the input of Soundbar item NV-P500-EU which plays high quality sound in the room by means of its indoor speakers and the connected subwoofer.

Use the tabletop players item NV-P400-EU to listen to music in the bedrooms.

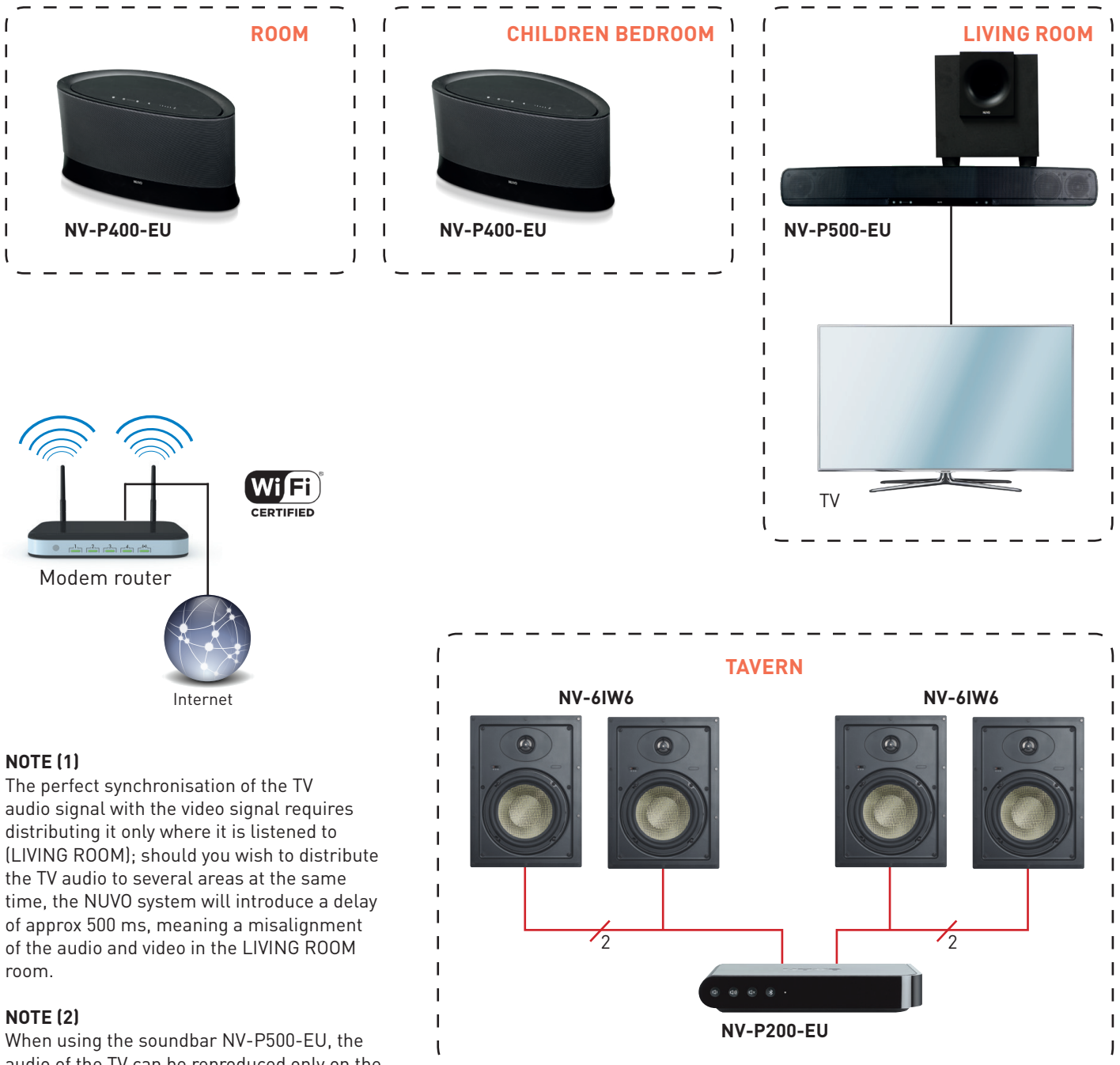

**NOTE (1)**

The perfect synchronisation of the TV audio signal with the video signal requires distributing it only where it is listened to (LIVING ROOM); should you wish to distribute the TV audio to several areas at the same time, the NUVO system will introduce a delay of approx 500 ms, meaning a misalignment of the audio and video in the LIVING ROOM room.

**NOTE (2)**

When using the soundbar NV-P500-EU, the audio of the TV can be reproduced only on the soundbar itself. It cannot be distributed to other NUVO zones.

# CATALOGUE

## Zone player



NV-P100-EU



NV-P4300-EU







NV-P500-EU

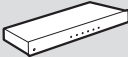

NV-P400-EU

Item	ZONE PLAYER FOR WIRED SYSTEMS
<p><b>NV-P3100-EU</b></p> 	<p>Professional Rack version. Allows the management of 3 zones with rated output power for each zone of 2x20 W RMS. USB inputs and 3.5 mm jack to connect any other device - Speaker output impedance: 6 - 8Ω.</p>
<p><b>NV-P4300-EU</b></p> 	<p>Professional Rack version. Allows the management of 3 zones with rated output power for each zone of 2x55 W RMS with speakers of 8 Ω, 6Ω and 4Ω. USB and RCA inputs to connect any other device. It has a front touch screen to set and manage the functions.</p>

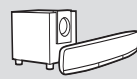
Item	ZONE PLAYER FOR WIRELESS AND WIRED SYSTEMS
<p><b>NV-P100-EU</b></p> 	<p>Wireless zone Player, Stereo Amplifier 2 x 20 W RMS. From the zone Player, it is possible to access the contents through the wireless or wired network. USB input and 3.5 mm jack to connect any other device. Speaker output impedance: 6 - 8Ω</p>
<p><b>NV-P200-EU</b></p> 	<p>Wireless zone Player, Stereo Amplifier 2 x 60 W RMS, aptX Bluetooth code. From the zone Player, it is possible to access the contents through the wireless or wired network. USB input and 3.5 mm jack to connect any other device. Speaker output impedance: 4 - 6 - 8Ω</p>
<p><b>NV-P300-EU</b></p> 	<p>Wireless zone player with preamplifier function made for linking to an audio or audio/video amplifier of other brands to play sound in the room to which it belongs. From the zone Player, it is possible to access the contents through the wireless or wired network. USB input and 3.5 mm jack for analogue and digital connection to the amplifier.</p>
<p><b>NV-P400-EU</b></p> 	<p>Tabletop speaker 2.1 combined with a zone player to listen to your favourite music in every room of the home. Intended for tabletop installation, it can be used as a single zone player or as an extra player to extend the zones of an existing system.</p>
<p><b>NV-P500-EU</b></p> 	<p>Soundbar 2.1 equipped with wireless 8" subwoofer. As well as its Home Theater use, the Soundbar can be used as a player of just one zone to listen to all the music available in the home network devices or in the various streaming services via Internet.</p>
<p><b>NV-P600</b></p>	<p>Din Rail Player 1 input 3,5 mm, USB, total 40 W.</p>
<p><b>NV-P601</b></p>	<p>Din Rail Power Supply Power up to 4 P600 players 24V/18W per zone</p>

# CATALOGUE

## Control devices



NV-P30-BK



NV-P20-LLN

Item	7" TOUCH SCREEN
NV-P30-BK	7" capacitive touch screen with resolution 1024 x 600 pixels to control all the NUVO system functions. Connection to the wired LAN via RJ45 cable and PoE power supply. Supplied with universal support for wall surface mounting.



Item	KEYPAD
	Capacity control with backlit front cover to manage the basic functions of a single zone Player. Control of the play, pause, volume, mute and track search functions. Pushbutton to access your 5 favourite sources. Connection to the wired LAN via RJ45 cable and PoE power supply. 2 modules.
<input type="checkbox"/> NV-P20-LLN <input checked="" type="checkbox"/> NV-P20-LLNT <input checked="" type="checkbox"/> NV-P20-LLNL  <input checked="" type="checkbox"/> NV-P20-ARMG <input type="checkbox"/> NV-P20-ARWH	<b>Livinglight</b>  <b>Arteor</b> magnesium white
NV-NV-P2X	Accessory for the Keypad device to connect to the LAN. Length 15 cm
<input type="checkbox"/> NV-P20-VLWH <input checked="" type="checkbox"/> NV-P20-VLIV <input checked="" type="checkbox"/> NV-P20-VLAL	<b>Valena Life</b> white ivory aluminium





## Speakers SERIES 2



NV-2IC6



NV-2IC8-ANG



NV-2IW6

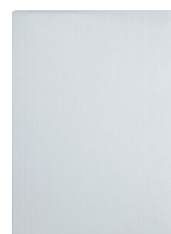

Item	FOR CEILING INSTALLATION	
NV-2IC6		6.5" ceiling speaker, Series 2 (a pair) 50W RMS 8Ω
NV-2IC6-ANG		6.5" ceiling speaker, Series 2 (single) 50W RMS 8Ω - angle
NV-2IC6-DVC		Ceiling speaker with double tweeter 6.5" Series 2 (single) 50W RMS 8Ω
NV-2IC8		8" ceiling speaker, Series 2 (a pair) 50W RMS 8Ω
NV-2IC8-ANG		8" ceiling speaker, Series 2 (single) 50W RMS 8Ω - angle

Item	FOR WALL AND FLUSH MOUNTED INSTALLATION	
NV-2IW6		6.5" wall speaker Series 2 (a pair) 50W RMS 8Ω. For flush mounted installation in cement or brick walls, use the box item NV-BOXIW6.

**NOTE:** all speakers are supplied with finish grid.

TECHNICAL DATA						
	NV-2IC6	NV-2IC6-ANG	NV-2IC6-DVC	NV-2IC8	NV-2IC8-ANG	NV-2IW6
Frequency	60 Hz - 20 KHz	60 Hz - 20 KHz	55 Hz - 20 KHz	45 Hz - 20 KHz	45 Hz - 20 KHz	60 Hz - 20 KHz
Impedance	8 Ohms	8 Ohms	8 Ohms	8 Ohms	8 Ohms	8 Ohms
Sensitivity	86 dB	86 dB	86 dB	86 dB	86 dB	86 dB
RMS power	50 W	50 W	50 W	50 W	50 W	50 W
Peak power	100 W	100 W	100 W	100 W	100 W	100 W
Woofer material	Polypropylene	Polypropylene	Polypropylene	Polypropylene	Polypropylene	Polypropylene
Tweeter material	Silk	Silk	Silk	Silk	Silk	Silk
Weight (kg)	3.28	1.80	1.97	1.97	2.58	3.60
Dimensions of the Woofer	165 mm	165 mm	165 mm	203 mm	203 mm	165 mm
Dimensions of the Tweeter	13 mm	13 mm	13 mm	13 mm	13 mm	13 mm
Dimensions	230 mm	230 mm	230 mm	270 mm	285 mm	220 mm x 300 mm
Size for flush mounting	205 mm	205 mm	205 mm	246 mm	258 mm	194 mm x 274 mm
Depth for flush mounting	99 mm	116 mm	99 mm	111 mm	135 mm	83 mm

# CATALOGUE

## Speakers SERIES 4



NV-4IC6









NV-4IC6-DVC



NV-4IW6



Item	FOR CEILING INSTALLATION	
<b>NV-4IC6</b>		6.5" ceiling speaker, Series 4 (a pair) 75W RMS 8Ω
<b>NV-4IC6-ANG</b>		6.5" ceiling speaker, Series 4 (single) 75W RMS 8Ω - angle
<b>NV-4IC6-DVC</b>		Ceiling speaker with double tweeter 6.5" Series 4 (single) 75W RMS 8Ω
<b>NV-4IC8</b>		8" ceiling speaker, Series 4 (a pair) 75W RMS 8Ω
<b>NV-4IC8-ANG</b>		8" ceiling speaker, Series 4 (single) 75W RMS 8Ω - angle

Item	FOR WALL AND FLUSH MOUNTED INSTALLATION	
<b>NV-4IW6</b>		6.5" wall speaker Series 4 (a pair) 75W RMS 8Ω. For flush mounted installation in cement or brick walls, use the box item NV-BOXIW6.

**NOTE:** all speakers are supplied with finish grid.

TECHNICAL DATA						
	NV-4IC6	NV-4IC6-ANG	NV-4IC6-DVC	NV-4IC8	NV-4IC8-ANG	NV-4IW6
Frequency	55 Hz - 20 KHz	55 Hz - 20 KHz	50 Hz - 20 KHz	40 Hz - 20 KHz	40 Hz - 20 KHz	55 Hz - 20 KHz
Impedance	8 Ohms	8 Ohms	8 Ohms	8 Ohms	8 Ohms	8 Ohms
Sensitivity	88 dB	88 dB	88 dB	88 dB	88 dB	88 dB
RMS power	75 W	75 W	75 W	75 W	75 W	75 W
Peak power	150 W	150 W	150 W	150 W	150 W	150 W
Woofer material	Glass fibre	Glass fibre	Glass fibre	Glass fibre	Glass fibre	Glass fibre
Tweeter material	Aluminium	Aluminium	Aluminium	Aluminium	Aluminium	Aluminium
Weight (kg)	3.72	2.01	2.26	4.35	2.58	3.95
Dimensions of the Woofer	165 mm	165 mm	165 mm	203 mm	203 mm	165 mm
Dimensions of the Tweeter	19 mm	19 mm	19 mm	19 mm	19 mm	19 mm
Dimensions	230 mm	230 mm	230 mm	270 mm	285 mm	220 mm x 300 mm
Size for flush mounting	205 mm	205 mm	205 mm	246 mm	258 mm	194 mm x 274 mm
Depth for flush mounting	100 mm	121 mm	100 mm	112 mm	141 mm	83 mm

## Speakers SERIES 6



NV-6IC6







NV-6IC8-ANG

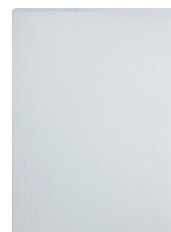

NV-6IW6



Item	FOR CEILING INSTALLATION	
<b>NV-6IC6</b>		6.5" ceiling speaker, Series 6 (a pair) 100 W RMS 8Ω
<b>NV-6IC6-ANG</b>		6.5" ceiling speaker, Series 6 (single) 100 W RMS 8Ω - angle
<b>NV-6IC8</b>		8" ceiling speaker, Series 6 (a pair) 100 W RMS 8Ω
<b>NV-6IC8-ANG</b>		8" ceiling speaker, Series 6 (single) 100 W RMS 8Ω - angle

Item	FOR WALL AND FLUSH MOUNTED INSTALLATION	
<b>NV-6IW6</b>		6.5" wall speaker Series 6 (a pair) 100 W RMS 8 Ω. For flush mounted installation in cement or brick walls, use the box item NV-BOXIW6.

**NOTE:** all speakers are supplied with finish grid.

TECHNICAL DATA					
	NV-6IC6	NV-6IC6-ANG	NV-6IC8	NV-6IC8-ANG	NV-6IW6
Frequency	60 Hz - 20 KHz	60 Hz - 20 KHz	35 Hz - 20 KHz	35 Hz - 20 KHz	50 Hz - 20 KHz
Impedance	8 Ohms	8 Ohms	8 Ohms	8 Ohms	8 Ohms
Sensitivity	89 dB	89 dB	89 dB	89 dB	89 dB
RMS power	100 W	100 W	100 W	100 W	100 W
Peak power	200 W	200 W	200 W	200 W	200 W
Woofer material	Kevlar/Carbon Fibre Weave	Kevlar/Carbon Fibre Weave	Kevlar/Carbon Fibre Weave	Kevlar/Carbon Fibre Weave	Kevlar/Carbon Fibre Weave
Tweeter material	Titanium	Titanium	Titanium	Titanium	Titanium
Weight (kg)	3.79	2.01	4.35	2.58	3.95
Dimensions of the Woofer	165 mm	165 mm	203 mm	203 mm	165 mm
Dimensions of the Tweeter	25 mm	25 mm	25 mm	25 mm	25 mm
Dimensions	230 mm	230 mm	270 mm	285 mm	220 mm x 300 mm
Size for flush mounting	205 mm	205 mm	246 mm	258 mm	194 mm x 274 mm
Depth for flush mounting	100 mm	121 mm	112 mm	141 mm	83 mm

# CATALOGUE



## Series 2 and Series 6 outdoor speakers - wall-mounted installation



NV-20D6-WH



NV-20D6-BK

Item	SERIES 2
NV-20D6-WH	6.5" speaker white colour (a pair) 50 W RMS 8 Ω
	
NV-20D6-BK	6.5" speaker black colour (a pair) 50 W RMS 8 Ω
	

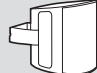
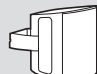
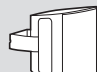
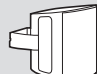
Item	SERIES 6
NV-60D6-WH	6.5" speaker white colour (a pair) 60 W RMS 8 Ω
	
NV-60D6-BK	6.5" speaker black colour (a pair) 60 W RMS 8 Ω
	
NV-60D6-DVC-WH	6.5" stereo speaker white colour 60 W RMS 8 Ω
	
NV-60D6-DVC-BK	6.5" stereo speaker black colour 60 W RMS 8 Ω
	

TECHNICAL DATA			
	NV-20D6-WH NV-20D6-BK	NV-60D6-WH NV-60D6-BK	NV-60D6-DVC-WH NV-60D6-DVC-BK
Frequency	60Hz - 20KHz	55Hz - 20KHz	55Hz - 20KHz
Impedance	8 Ohms	8 Ohms	8 Ohms
RMS power	50 Watts	60 Watts	60 Watts
Peak power	100 Watts	120 Watts	120 Watts
Dimensions	195mm x 328mm x 178mm	195mm x 328mm x 178mm	195mm x 328mm x 178mm

# CATALOGUE

## Installation accessories and finish grids



NV-RGIC6



NV-RGIW6



NV-BOXIW6

Item	FLUSH MOUNTED BOX
NV-BOXIW6	Metal box for installation of the speakers item NV-2IW6, item NV-4IW6 and item NV-6IW6 on brick walls.

SUPPORTS FOR CEILING SPEAKERS	
NV-BRKIC6 	Fixing system for 6.5" ceiling speakers (a pair)
NV-BRKIW6 	Fixing system for 6.5" wall speakers (a pair)
NV-BRKIC8 	Fixing system for 8" ceiling speakers (a pair)
NV-BRKIC6-ANG	Fixing system for 6.5" ceiling angle speaker
NV-BRKIC8-ANG	Fixing system for 8" ceiling angle speaker

Item	ROUND FINISH GRIDS
NV-RGIC6	Pair of grids for ceiling speakers with 6.5" diameter.
NV-RGIC6-ANG	Pair of grids for ceiling angle speakers with 6.5" diameter.
NV-RGIC8	Pair of grids for ceiling speakers with 8" diameter.
NV-RGIC8-ANG	Pair of grids for ceiling angle speakers with 8" diameter.

RECTANGULAR FINISH GRIDS	
NV-RGIW6	Pair of grids for wall rectangular speakers with 6.5" diameter.



Use of the box item NV-BOXIW6 for the installation of the speaker item NV-6IW6

# NOTES

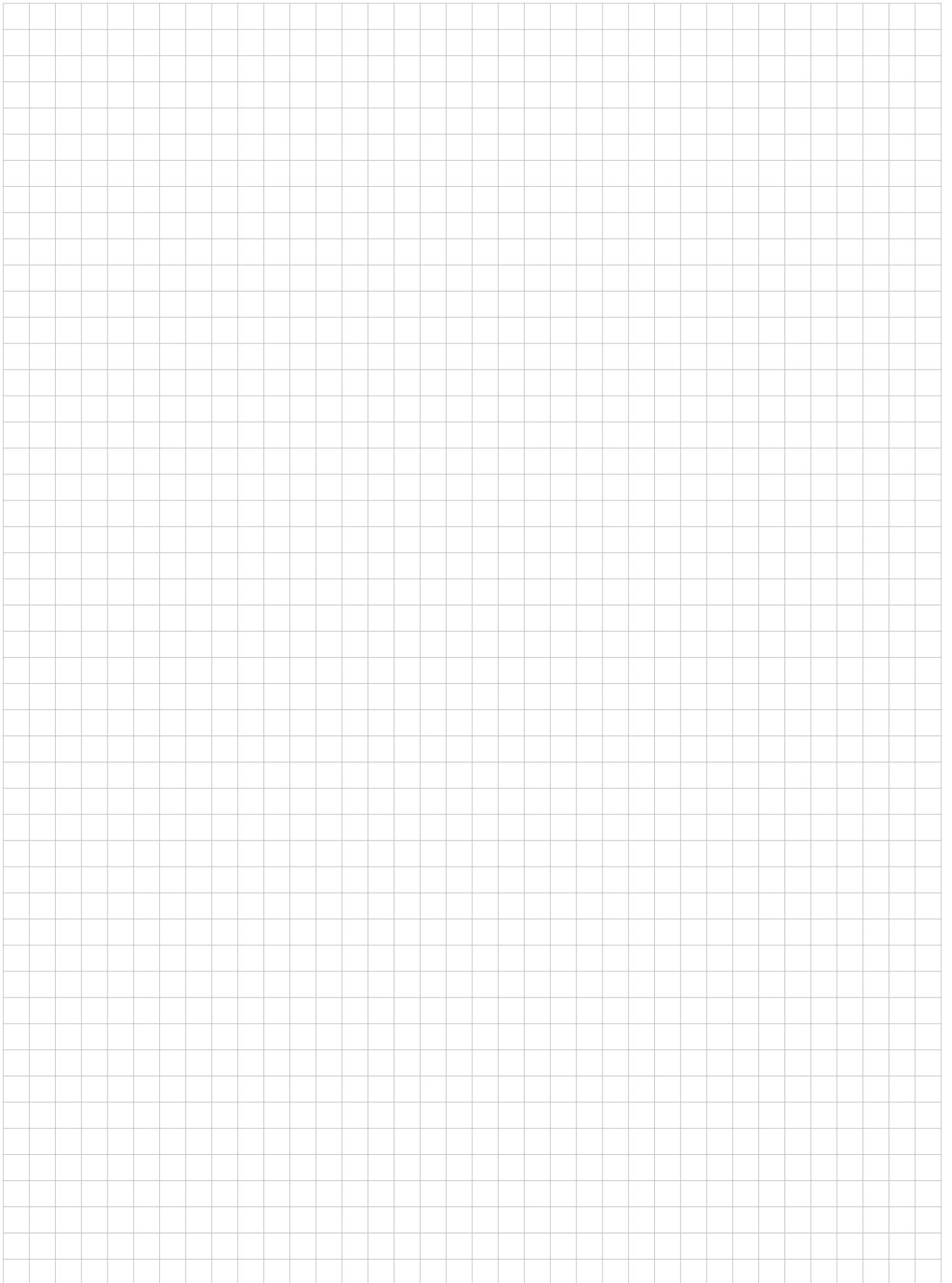





## FOLLOW US ALSO ON

@ Web site: [www.legrand.com](http://www.legrand.com)

 [www.youtube.com/legrand](http://www.youtube.com/legrand)

 [www.twitter.com/legrand](http://www.twitter.com/legrand)



**World Headquarters**  
and International Department  
87045 Limoges Cedex - France  
Tel. : + 33 (0) 5 55 06 87 87  
Fax : + 33 (0) 5 55 06 74 55